

# Sta. Rosa Motor Works, Inc.

## Modern PUV Standard Specifications

### HINO XZU 342 LJ

#### MODEL

Model	SR - PUV AIRCONDITIONED (Class II)
Seating Capacity	Passengers (20) Driver (1)
Seat Arrangement	Parallel Facing

#### BODY

Type	Structural Frame Body Construction
Body Materials	Side Panels - Galvanized Sheet
	Front and Rear Panels - Molded FRP
	Roof Panel - FRP
Painting	Main Body Surface - 2K PU Paint System
	Under Body - Undercoating

#### DOOR

Service Door	Folding Type with Electric Door Closer
--------------	--

#### WINDOWS

Front Windshield	Laminated Safety Glass
Drivers Window	Lower Sliding
Side Windows	Tempered Safety Glass
Rear Window	Tempered Safety Glass

#### INTERIOR/EXTERIOR

Floor Board and Covering	Marine Plywood and PVC Non Slip Covering
Side Panels	ABS Plastic
Ceiling	Aluminum Composite
Hand Rails	Stainless Tubing
Aircon Ducting (LH/RH)	Overhead
Upholstery	Synthetic Leather
Insulation	Equipped
Inner View Mirror	Equipped
Side View Mirror (LH/RH)	Equipped

#### ELECTRICAL

Headlights	Equipped
Tail Lights	Equipped
Signal Lights	Equipped
Side Lights	Equipped
Clearance Lamps (FR/RR)	Equipped
Room Lamps	Equipped
Third Brake Light	Equipped
* FOG LIGHTS	<b>Equipped</b>
* STEREO & 4 PCS SPEAKERS	<b>Equipped</b>

#### AIRCONDITIONER

Type	Direct Drive Roof Mounted
Air Outlet	Adjustable Louvers

#### OTHER FEATURES

Designated Priority Seats  
 Safety Seatbelts (6 pcs)  
 Fire Extinguisher  
 Emergency Glass Hammer

Note : The manufacturer reserve the right to change the specifications without prior notice.

\* Specifications revision requested by HMPC. (Refer to optional quote)

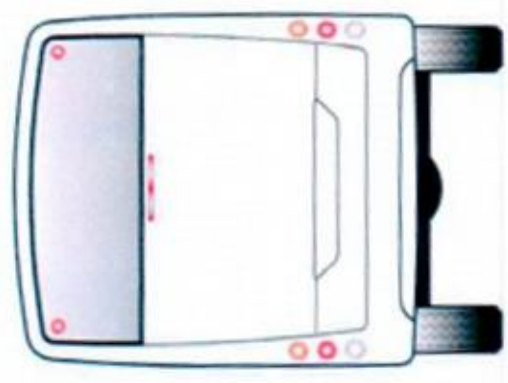
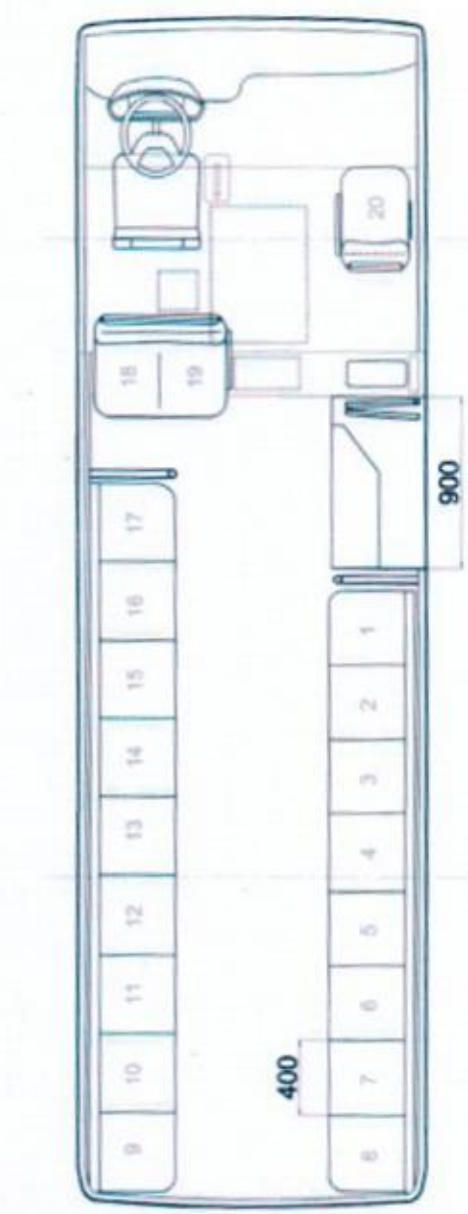
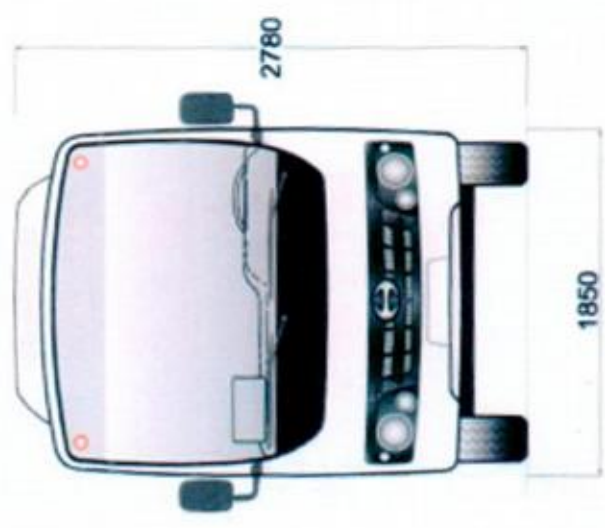
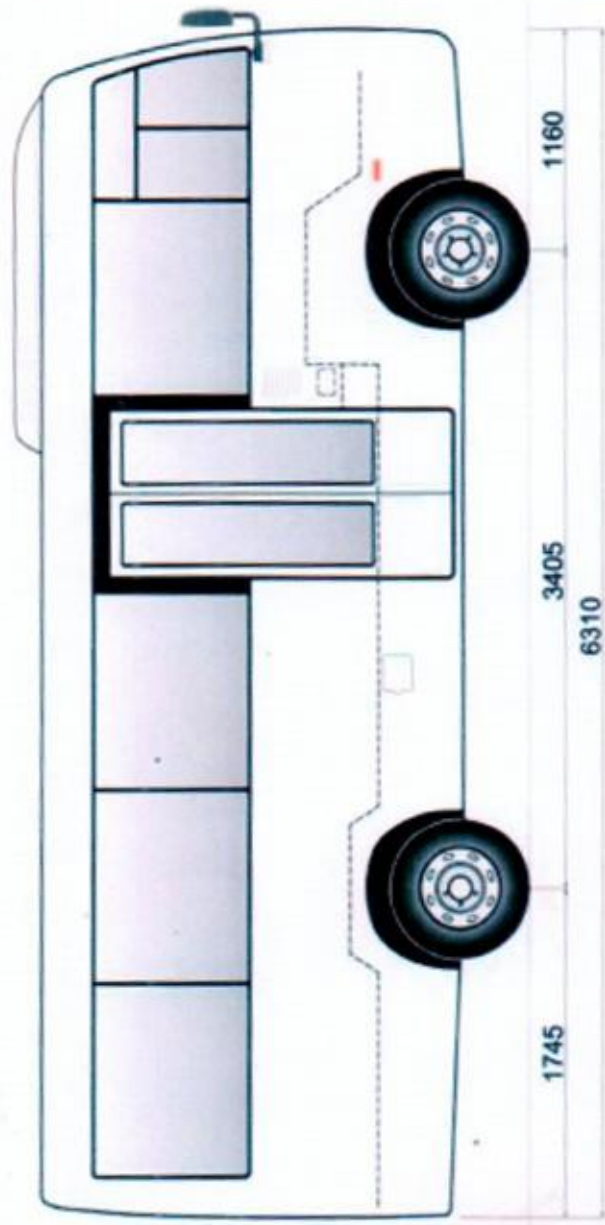

NOTE: 1. Above design is for presentation purposes only, it may vary in actual.  
 2. The information contained in this drawing is the sole property of STA. Rosa Motor Works, Inc.  
 Any reproduction in part or as a whole without the written permission of STA. Rosa is prohibited.



**STA. ROSA MOTOR WORKS, INC.**  
 ENGINEERING DEPARTMENT  
 No. 17 So. 81st St. Bldg. 119000

**PRESENTATION DRAWING**

APPROVED:	MALA	DESIGNED:	CFE
REVISIONS:	507041	DRAWN:	GRD
MODEL:	<b>SR PUV (AIRCONDITIONED)</b>		
SHORT MODEL:	20 * 1 M/STANDING (CLASS 11)		
CHASSIS MODEL:	HNO XZU 342 LJ		
CUSTOMER:	HMPC		

FILE NAME:	PUL-CENTRAL DATA		
DATE RELEASED:	11-09-19		
SCALE:	FREE SCALE		
	ALL DIM IN MM		

